

QUICK START OF AMZ SOLAR AWNING BLIND

The ZWP SA 4 remote control is supplied in one packaging with the awning blind.
The awning blind is factory programmed on channel No. 1 !!!

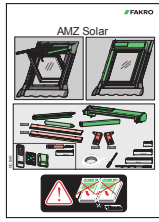

Install the awning blind in accordance with the NC94X fitting instructions

Put batteries in the controller

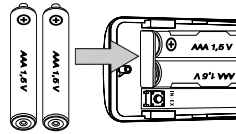

Check the operation of the awning blind unfolding

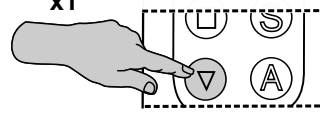

Check the operation of the awning blind folding

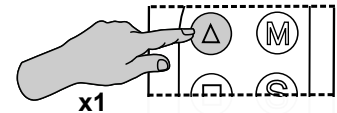

If the awning blind is working correctly you do not need to perform the following steps !!!

Information concerning programming, change of parameters, changes in configuration settings, calling individual functions is contained in the **Programming and Usage Instructions (code NC97B)**.

The awning blind is equipped with the **manual operating button** positioned in its upper part. It enables control of the awning blind in case of losing the remote control or wearing off its batteries. If after mounting the awning blind cannot be launched via the remote control, check operation with the **manual operating button**.

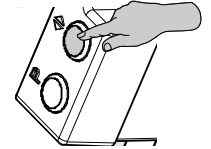

If the awning blind works with the manual operating button, and yet it cannot be launched via remote control, make **RESET** and go to **PROGRAMMING** !!!

RESET

RESET OF THE AWNING BLIND

1 max 10s.

2 max 10s.

RESET OF THE REMOTE CONTROL

3 max 1.5s.

4 max 10s.

ADDITIONAL INFORMATION

- Screw out the screw on the back of the remote control.
- Pull out up back part of the remote control to access IN/EX programming button.

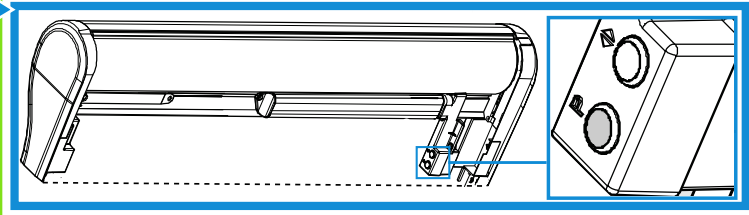

PROGRAMMING

SIGNALLING

1 max 10s.

2 max 10s.

3 max 10s.

4 max 10s.

Choose one of four available channels e.g. No. 1

- 1 – channel one – control of the awning blind No. 1
- 2 – channel two – control of the awning blind No. 2
- 3 – channel three – control of the awning blind No. 3
- 4 – channel four – control of the awning blind No. 4
- 1 2 3 4 - joint channel – simultaneous control of max. four awning blinds

END OF PROGRAMMING

1 max 10s.

- button for channel selection
- button for manual mode selection
- button for semi-automatic mode selection
- button for automatic mode selection
- button for folding the awning blind's fabric
- button for stopping the awning blind's fabric in desired position
- button for unfolding the awning blind's armour

Calling up other procedures such as DELETE, EXCLUDE, LEARN MODE, DEVICE CONNECTION is described in the programming and usage instructions attached to the AMZ Solar awning blind. Information on how to perform programming of Z-Wave devices with the use of controllers of other manufacturers is to be found in the manuals of these devices.